

3-Axis Gimbal Chassis

#### Features

- High-impact polycarbonate housing
- High resolution colour Sony CCD
- Day Mode: 540 TVL, Night Mode: 570 TVL
- 0.65 Lux @ F1.2
- User configurable LL, BLC, AGC, AWB, Flickerless,
- SDN (software day/night)
- Dual 12VDC/24VAC auto sensing power
- 2.9~10mm lens
- Optional Quick Install Pipe
- Optional UTP transmission kit
- Service jack

#### Order Codes

Vi-C2WC	100mm Indoor Mini Dome, White, Clear
Vi-C2WD	100mm Indoor Mini Dome, White, Dummy
Vi-C2BC	100mm Indoor Mini Dome, Black, Clear
Vi-C2WD	100mm Indoor Mini Dome, Black, Dummy

#### Accessories

Vi-C2/QIP	Quick Install Kit
Vi-C2/SVC	Service cable
Vi-C2/UTP	Twisted pair transmission kit

#### Overview

These mini domes are the industry leader in terms of colour camera performance, ease of installation, configuration choices and mounting options. Featuring the latest in CCD and DSP technology, offering exceptional low light performance, accurate colour reproduction and 540 TVL of resolution. This is matched with a high quality 2.9~10mm Auto Iris lens, offering a range of focal lengths to suit the vast majority of applications.

The AC/DC Universal Switching Power Supply provides a choice of power options for the installer. The MD4 series has been designed for fast and efficient installation featuring load-able screws for quick and easy surface wall mount, or ceiling installation using the optional quick ceiling install kit. The unique 3-Axis camera gimbal allows unrestricted configuration of lens position, focal length adjustment and focusing.

The mini domes are ideally suited for all applications where enhanced resolution and sensitivity are required, such as shopping centres, car parks, schools and airports.

### Technical Data

#### General

Image Size	Sony 1/3 Format Interline CCD Sensor
Pixel Element	752 (H) × 582 (V) approx. 430K pixels
Scanning Frequency	PAL 2 : 1 Interlace / H : 15625Hz , V : 50.0Hz
Operation Temperature	-10°C ~ +50°C
Storage Temperature	-20°C ~ +65°C
Power Source	AC power supply 19.0VAC ~ 28.0VAC
DC power supply	10.0VDC ~ 30VDC
Power Consumption	4.2W Max
Lens Type	Varifocal
Focal Length	2.9mm to 10mm, F1.2 Lens
Mount	Direct Mount
External Dimensions	Ø120X100(H) mm
Weight	330g

#### Function

Exposure Control	DC Auto IRIS Drive
Auto IRIS Control	DC Drive
Video IRIS Output	1.0Vpp (100IRE Video Output)
BLC	Centre Area for Auto IRIS
White Balance	Auto White Balance
AWB Range	AWB: 2700K ~ 11000K AWB-EX: 2000K ~ 18000K
Day & Night Software	Day/Night Feature
AGC	Boost Enhanced AGC Gain to Max. 30dB
SYNC System	INT / Line Lock
Line Lock	Phase Adjust Range 0°~ 270° Frequency Range 50Hz +/- 1Hz

#### Video

Resolution	Day Mode: 540 TVL Night Mode: 570 TVL
Minimum Illumination	0.65 Lux @ F=1.2 (50IRE Video Output)
Video Output	1.0Vpp 75Ohm BNC unbalanced
S/N Ratio	50dB
AGC Ex Gain	30dB
AGC Preset Gain	26dB
H Aperture	10 IRE (r 0.45 100IRE Video Output)
V Aperture	10 IRE

#### Function Control

Exposure Control	DC Drive with variable-Resistor
Software Day/Night	OFF / ON
Back Light Compensation	OFF / ON
AGC Selectable	AGC-EX / AGC Norm
SYNC System	INT / LL
Flicker-less	OFF / ON
Auto White Balance	AWB / AWB-EX
Line Lock	Vertical Phase Var.-Resistor on Side Panel
DC IRIS Level Control	Var.-Resistor on Side Panel

#### Lens

Type of Focal	Varifocal, 2.9~10mm
Type of Iris	DC Drive Auto-Iris
Iris Range	F1.2 ~ 360
Field of View	Diagonal: 125°~36° Horizontal: 94.6°~28.8° Vertical: 68.4°~21.6°
Minimum Object Distance	0.15m
Lens Type	Aspherical

#### Vi-C2/QIPQuick Install Kit

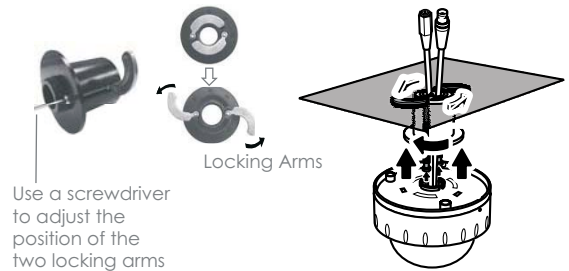

#### DIP switch

